

[Hochladen](#)[alvaroprudente](#)[Öffentliches Profil ansehen](#)[Recently Read](#)[My Library](#)[Social Feed](#)[My Uploads](#)[My Collections](#)[My Stats](#)[Konto](#)[Help](#)[Abmelden](#)[Browse](#)[Books](#)[Fiction & Literature](#)[Romance](#)[Science Fiction](#)[Body, Mind & Spirit](#)[Religion](#)[Business](#)[History](#)[Science](#)[Travel](#)[Self-help](#)[Cookbooks and Food](#)[Other Content](#)[School Work](#)[How-To Guides/Manuals](#)[Research](#)[Comics](#)[Magazines/Newspapers](#)[Presentations](#)[Government & Politics](#)[Brochures & Catalogs](#)[Recipes/Menus](#)[Creative Writing](#)[My Library](#)[Recently Saved](#)

Loading...

[Go to My Library →](#)

Read without ads and support Scribd by becoming a Scribd Premium Reader.

[See Premium Plans](#)

×

Sprache:

[Deutsch](#)









## INTAKE-AIR SYSTEM

### WL Turbo

1. Disconnect the negative battery cable.
2. Drain the engine coolant from radiator. (Refer to Section E, COOLING SYSTEM, ENGINE COOLANT REPLACEMENT.)
3. Remove the front mud guard. (Refer to Section S, FRONT FENDER PANEL, FRONT FENDER PANEL REMOVAL/INSTALLATION.)
4. Remove the injection pipe. (Refer to FUEL SYSTEM, INJECTION NOZZLE REMOVAL/INSTALLATION.)
5. Remove in the order indicated in the table.
6. Install in the reverse order of removal.
7. Refill the engine coolant to radiator. (Refer to Section E, COOLING SYSTEM, ENGINE COOLANT REPLACEMENT.)

#### STEP 1

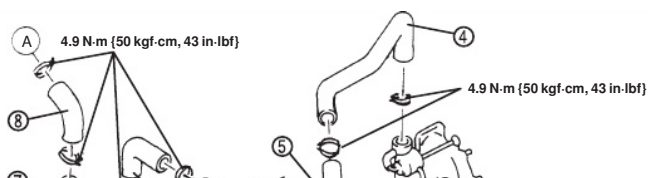

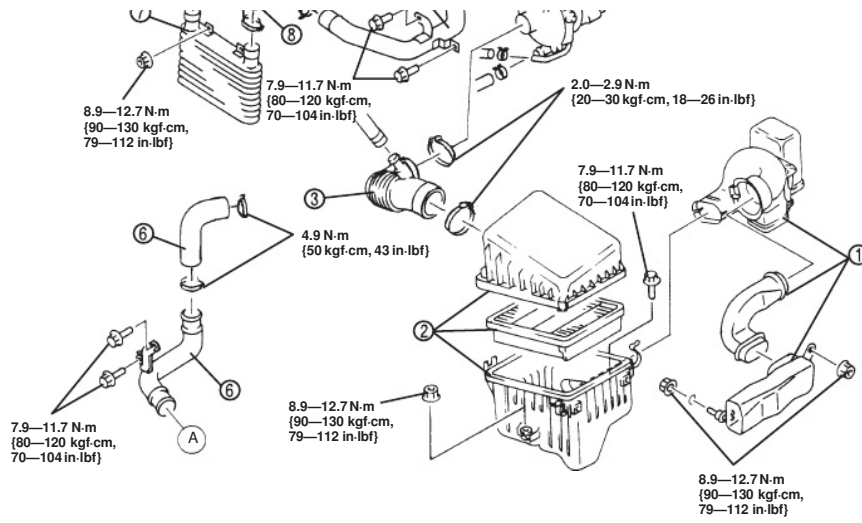

1	Fresh-air duct
2	Air cleaner
3	Air intake hose
4	Air hose

5	Air intake pipe
6	Air hose
7	Charge air cooler
8	Air hose

## F2-8

### INTAKE-AIR SYSTEM

STEP 2

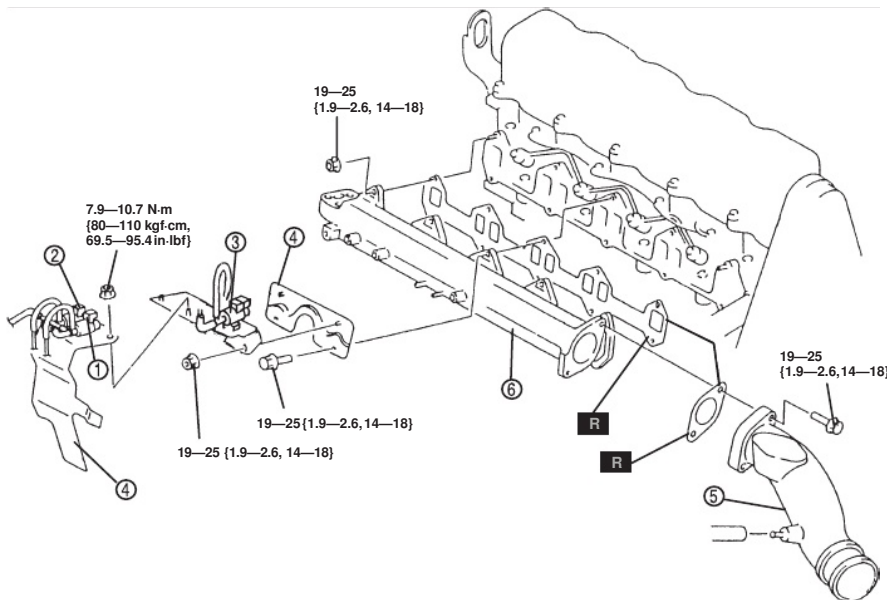

N-m {kgf-m, ft.lbf}

1	FICD solenoid valve No.1
2	FICD solenoid valve No.2
3	EGR solenoid valve

4	FICD solenoid valve bracket
5	Air intake pipe
6	Intake manifold

### F2-9

## INTAKE-AIR SYSTEM

### TURBOCHARGER INSPECTION Wastegate Actuator Inspection

**Caution**

- Compressed air used in the workshop is highly pressurized and can damage the actuator. Adjust the air pressure with a transformer, and inspect the actual pressure by using an air blower before actual use. Stop blowing air if the rod moved.

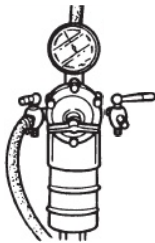

1. Disconnect the air hose of the wastegate actuator on the compressor housing side.
2. Apply the compressed air using the air gun. Note the air pressure when the wastegate actuator is moved.

**Specification**

107—115 kPa  
{1.09—1.18 kgf/cm<sup>2</sup>, 15.5—16.8 psi}

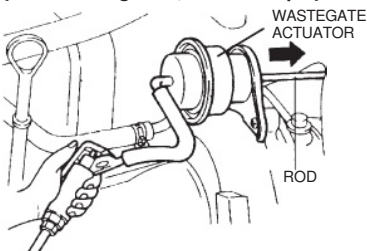

4. If not within the specification, replace the turbocharger. (Refer to EXHAUST SYSTEM, EXHAUST SYSTEM REMOVAL/INSTALLATION.)

### Compressor Wheels Inspection

1. Remove the air hose. (Refer to INTAKE-AIR SYSTEM, INTAKE-AIR SYSTEM REMOVAL/INSTALLATION.)
2. Remove the joint pipe. (Refer to EXHAUST SYSTEM, EXHAUST SYSTEM REMOVAL/INSTALLATION.)
3. Set the small mirror as shown and inspect the compressor wheel from view A.

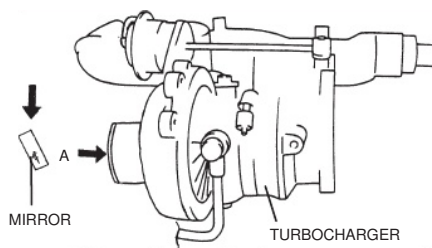

4. Inspect all fins of compressor wheel while rotating the compressor wheel by hand.
5. If the compressor wheel is interfering with the housing, it is likely that more than two fins are damaged, cracked or bent. Replace the turbocharger.

**Note**

- If scratches are found inside the housing but the fins are okay, the turbocharger is okay. Scratches are made in the turbocharger made by factory.

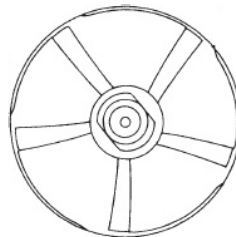

### Turbine Wheels Inspection

1. Remove the air hose. (Refer to INTAKE-AIR SYSTEM, INTAKE-AIR SYSTEM REMOVAL/INSTALLATION.)
2. Remove the joint pipe. (Refer to EXHAUST SYSTEM, EXHAUST SYSTEM REMOVAL/INSTALLATION.)
3. Set the small mirror as shown and inspect the turbine wheel from view B.

**Note**

- To make work accurate, use a penlight to inspect.

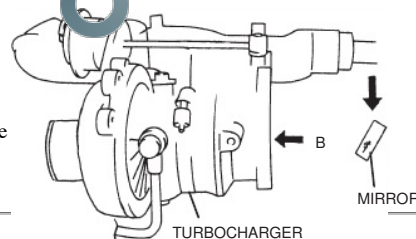

4. Inspect all fins of turbine wheel while rotating the turbine wheel by hand.

Download  
ZurückAdd Note  
Link  
Einbinden  
Saved

10  
Readcast

Nicht GeReadcast

Hinweis: Sie können jederzeit auf den Button Readcast klicken, um Inhalte

[Auto-Readcasting: OffView Past Readcasts](#)

[Undo](#)

**Note**

- To make work accurate, use a penlight to inspect.

Einen Kommentar hin:

Senden

[Auto-Readcasting: OffView Past Readcasts](#)

## INTAKE-AIR SYSTEM

- If the turbine wheel is interfering with the housing, it is likely that one or more fins are damaged, cracked or bent. Replace the turbocharger.

**Note**

- Grinding marks on the shaft are normal. This mark is for adjusting the shaft balance at the factory.

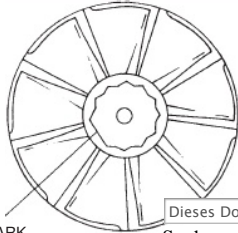

GRINDING MARK

Dieses Dokument dur

Suche

**GLOW PLUG REMOVAL/INSTALLATION:**

**Caution**

- Do not damage the heated section of the glow plug.
- Do not reuse a glow plug that has been dropped over a height of 10 cm, even when there are no scratches and resistance is normal (0.5 ohms at normal temperature).
- Do not remove the glow plug unless you are replacing it.

- Disconnect the negative battery cable.
- Remove in the order indicated in the table.
- Install in the reverse order of removal.

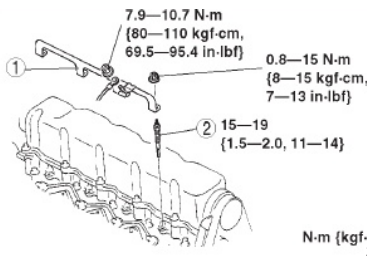

1	Glow plug cord
2	Glow plug (SeeGlow plug removal note) (SeeGlow plug installation note) (SeeGlow plug cleaning before installation note)

**Glow plug removal note**

- When removing the glow plug, first loosen it at least one pitch using a tool, then loosen by hand.

**Glow plug installation note**

- Tighten the glow plug it at least one pitch by hand, and continue tightening with a tool.

**Glow plug cleaning before installation note WL-3 / WLT-3 (Euro 3 Regulation Models)**

**Caution**

- Carbon on the glow plug can damage the glow plug and engine. Remove carbon on the glow plug and fitting holes before

**installing the glow plug.**

- Wrap tape on both a 5.5 mm and a 5.7 mm drills, starting from the tip to a point 50 mm from the tip.

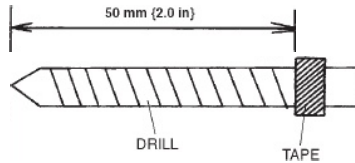

ZCF4010W002

- Push in the 5.5 mm drill until the section covered with tape is fully inserted.
- Turn the drill by hand to remove the carbon on the fitting holes.
- Repeat steps 2. and 3. for the 5.7 mm drill.

**GLOW PLUG INSPECTION**

**WL/ WL-T models**

- Remove the glow plug cord.
- Inspect the resistance between the glow plug terminal and the cylinder head.

**Specification**

**Glow plug resistance**  
Approx. 0.75 Ω [20 °C {68 °F}]

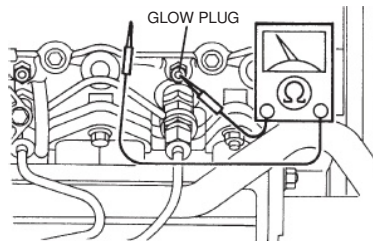

- If not as specified, replace the glow plug.

## F2-11

## INTAKE-AIR SYSTEM

**GLOW PLUG INSPECTION**

**WL-3 / WLT-3 (Euro 3 Regulation Models)**

- Remove the glow plug cord. (SeeGLOW PLUG REMOVAL/INSTALLATION.)
- Inspect for continuity between the glow plug terminal and the cylinder head using an ohmmeter.



**GLOW PLUG RELAY INSPECTION**

**System Inspection**

- Carry out the "Glow system inspection". (Refer to TROUBLESHOOTING, SYSTEM INSPECTION, Glow System Inspection.)
- If not as specified, perform the further inspection for the glow plug relay.

**Continuity Inspection**

**Note**

- Perform the following test only when directed.



YYJ4010W105

- If there is no continuity, replace the glow plug.

**Glow plug resistance**  
Approx. 0.5 ohm [20 C {68 F}]

3. Install the glow plug cord.

**GLOW PLUG RELAY REMOVAL/INSTALLATION**

1. Disconnect the negative battery cable.
2. Remove glow plug relay.
3. Install the glow plug relay.

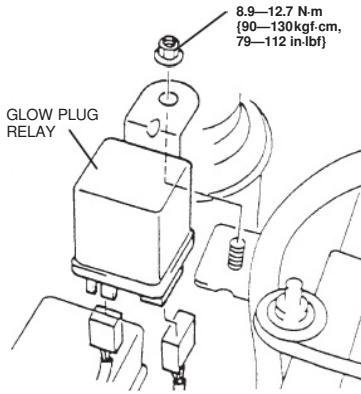

4. Connect the negative battery cable.

1. Remove the glow plug relay.
2. Inspect for continuity between terminals C and D of the glow plug relay under the following conditions.

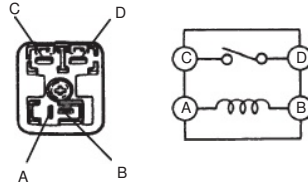

○—○ : Continuity

Step	A	B	C	D
1	B+	GND	○—○	
2	○	○		

3. If there is no continuity, replace the glow plug relay. (Refer to GLOW PLUG RELAY REMOVAL/INSTALLATION.) If as specified but the System Inspection is failed, inspect following:

**Open circuit**

- Power circuit (Glow plug relay connector terminal A (1-pin: R/B) and battery)
- Power circuit (Glow plug relay connector terminal A (2-pin) and PCM connector terminal O)
- GND circuit (Glow plug relay connector terminal A (1-pin: R) and glow plug cord)
- GND circuit (Glow plug relay connector terminal B (2-pin) and engine GND)
- Signal circuit (Glow plug relay connector terminal A (1-pin: R) and PCM connector terminal I)

**Short circuit**

- Glow plug relay connector terminal A (1-pin: R/B) and battery to GND.
  - Glow plug relay connector terminal A (2-pin) and PCM connector terminal O to GND.
  - Glow plug relay connector terminal A (1-pin: R) and PCM connector terminal I to GND.
4. Repair or replace faulty areas.
  5. Install the glow plug relay.

**F2-12**

**INTAKE-AIR SYSTEM**

**GLOW PLUG CORD INSPECTION**

1. Remove the glow plug cord. (Refer to GLOW PLUG REMOVAL/INSTALLATION.)
2. Verify that the glow plug cord is not broken or bent.
3. Verify there is continuity at both ends of the glow plug cord.
4. If there is no continuity, replace the glow plug cord.

**ACCELERATOR PEDAL REMOVAL/INSTALLATION**

1. Disconnect the negative battery cable.
2. Remove the column cover. (Refer to Section N, MANUAL STEERING WHEEL AND COLUMN REMOVAL/INSTALLATION.)
3. Remove in the order indicated in the table.
4. Install in the reverse order of removal.

**WL/ WL-T models**  
**General (R.H.D.)**

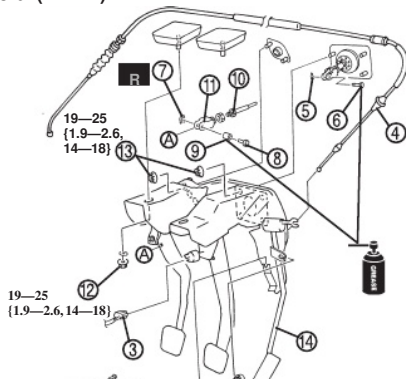

Except General (R.H.D.)

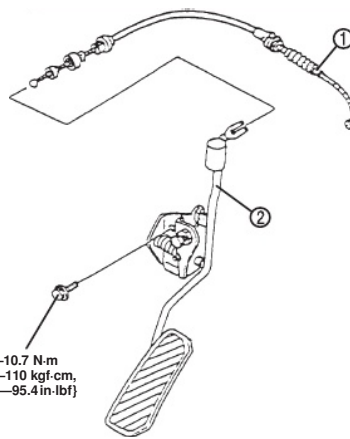

1	Accelerator cable + Installation Note
2	Accelerator pedal

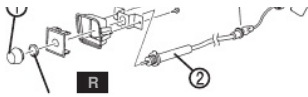

5.0 N·m (50 kgf·cm, 44  
in·lbf)

N·m (kgf·m, ft·lbf)

1	Idling knob
2	Idling cable
3	Brake switch connector
4	Accelerator cable + Installation Note
5	Spring pin
6	Clevis pin
7	E clip
8	Pin
9	Bushing
10	Push rod
11	Clevis
12	Nut
13	Nut
14	Pedal component + Installation Note

## F2-13



























































































































































































































# f2-1\_ps

Herunterladen oder Ausdrucken  
Zu Sammlung hinzufügen

106  
Reads

0  
Readcasts

0  
Embed Views



Published by

[pavel35](#)

[Folgen](#)

Dieses Dokument dur

Suche

TIPP Drücken Ctrl-F ⌘F um die Schnellsuche im Dokument zu starten.

## Get Scribd Mobile

To get Scribd mobile enter your number and we'll send you a link to the Scribd app for iPhone & Android. We've sent a link to the Scribd app. If you didn't receive it, try again.

(xxx) xxx-xxxx

Text me

We'll never share your phone number.

Or, click here and we'll send an email to your iPad and Android tablet. We've sent you an email with the link to the Scribd app. Didn't receive it? Try again.



[iTunes App Store](#) | [Google Play Store](#)

## Abschnitte

- [INJECTION TIMING ADJUSTMENT](#)
- [VACUUM HOSE ROUTING DIAGRAM](#)
- [GLOW PLUG REMOVAL/INSTALLATION](#)
- [GLOW PLUG CORD INSPECTION](#)
- [FUEL TANK REMOVAL/INSTALLATION](#)
- [FUEL FILTER DISASSEMBLY/ASSEMBLY](#)
- [FUEL FILTER AIR BLEEDING](#)
- [SEDIMENTOR WATER DRAINING](#)
- [FUEL INJECTION PUMP \(FIP\) INSPECTION](#)
- [EXHAUST SYSTEM INSPECTION](#)
- [ROLLOVER VALVE INSPECTION](#)
- [ON-BOARD DIAGNOSTIC SYSTEM](#)
- [TROUBLESHOOTING ITEM TABLE](#)

## Info und Bewertung

Kategorie: *Nicht eingeordnet.*

Bewertung:

Upload-Datum: 03/31/2013

Urheberrecht: Attribution Non-commercial

Tags: *Keine Tags*

Free ebook download as Text file (.txt), PDF File (.pdf) or read book online for free.

Flag for inappropriate content



.PDF



.TXT

Herunterladen



## Über uns

- [Über Scribd](#)
- [Team](#)
- [Blog](#)
- [Komme in unser Team!](#)
- [Kontaktieren Sie uns](#)

## Premium

- [Premium Reader](#)
- [Scribd Store](#)

## Werben Sie mit uns

- [Anfangen](#)
- [AdChoices](#)

## Support

- [Hilfe](#)
- [FAQ](#)
- [Presse](#)

## Partner

- [Entwickler/API](#)

## Gesetzlich

- [Terms](#)
- [Datenschutz](#)
- [Urheberrecht](#)

## Get Scribd Mobile



© Copyright 2013 Scribd Inc.

Sprache:

[Deutsch](#)